



# MM1000A

## DC INPUT SINGLE ALARM

### FIXED RANGE, DPDT RELAY

#### FEATURES

- Provides a DPDT Relay Contact Closure at a Preset DC Input
- Standard Fail-Safe Operation
- Green LED Relay Status Indicator
- Adjustable Deadband
- 1 V or 1 mA Minimum Input Span
- Unlimited\* Choice of Input Ranges
- Choice of Power Options
- 10 + 5 Year Warranty

#### DESCRIPTION

The MM1000A is a lower cost alternative to the MM1000 DC limit alarm for standard applications. The MM1000A monitors a DC input and trips a dpdt, 5 A relay when the input exceeds the desired level. The alarm has a green LED to indicate relay status.

Setpoint adjustment is provided by a 25-turn trimpot, adjustable from below 0% to above 100% of span.

Deadband, also a 25-turn trimpot, is adjustable from below 1% to above 100% of span. A user-changeable jumper may be changed to provide high or low trip.

All Wilkerson products are designed with RFI filters and lightning protection to reduce susceptibility to electrical noise and damage by lightning.

For options or input ranges not provided by MM1000A, refer to MM1000 or FR1000.

#### TYPICAL APPLICATIONS

DC Motor/current limit, level/position control, HI/LO pressure alarm, power demand warning.

#### SPECIFICATIONS

##### INPUT RANGE

Select any input range within the following limits:

##### Voltage

- Min span 1 V
- Max input 250 V
- Offset 0 V min,
- 100% of span max
- (example, +10/+20 V)

##### Current

- Min span 1 mA
- Max input 100 mA
- Offset 0 mA min,
- 100% of span max
- (example, +50/+100 mA)

##### INPUT IMPEDANCE

Voltage  
200 kilohms

##### Current

Current Input	Input Shunt Value
1 mA	100 Ohm
10 mA	10 Ohm
20 mA	5 Ohm
4/20 mA	61.9 Ohm
0/100 mA	2 Ohm
0/200 mA	1 Ohm
0/500 mA	0.1 Ohm
1 A	0.1 Ohm
2 A	0.05 Ohm
5 A	0.01 Ohm

##### SETPOINT

0 to 100% of span, min

##### DEADBAND

1% to 100% of span, min

##### RELAY CONTACTS (dpdt)

- Resistive Load
- 5 A max, 150 W max,
- 220 VAC max, 30 VDC max
- Inductive Load
- (Power factor 0.4)
- 2.5 A max, 75 W max,
- 220 VAC max, 30 VDC max

##### RESPONSE TIME

20 ms typical

##### ACCURACY

±0.1% of span

##### COMMON MODE REJECTION

120 dB, DC to 60 Hz

##### OPERATING TEMPERATURE

14°F to 140°F/-10°C to 60°C

##### TEMPERATURE STABILITY

±0.02% of span/°C max

##### POWER

- 115 VAC 10%, 50 or 60 Hz
- (2.5 W max)
- 230 VAC 10%, 50 or 60 Hz
- (2.5 W max)
- (DC Power Option)
- 24 VDC
- (limits 21 VDC to 32 VDC)
- (2.5 W max)

Isolation, DC power supply to input common: 10 megohms.

\* Within specified range limits.

**ORDERING INFORMATION**

**POWER**

- 115 VAC, 50/60 Hz Power
- 230 VAC, 50/60 Hz Power
- 12 VDC, Power, Transformer Isolated
- 24 VDC, Power, Transformer Isolated

**INPUT**

**Select Units**

- VDC  mADC

**Enter Input**

Zero Scale

Full Scale

**ALARMS**

**Alarm Type**

- High Normal / Low Reverse
- Low Normal / High Reverse

**OPTIONS**

- Conformal Coating

**TAGS**

**Specify Tag Numbers**

Tag number is typed on product label at no charge.

**Enter Tag Number(s)**

**ACCESSORIES**

**MM1000A**

DR1	DIN-Rail, 35 mm Symmetrical, 39 inches (1 meter)	Qty _____
MP011	Plastic Socket, 11-Pin, for Flat Surface or PVC Track	Qty _____
TRK48	PVC Snap-Track, 4 ft, for MP008, MP011, & DMP8500	Qty _____
DMP011	DIN-Rail Mounting Socket, 11-Pin, 35 mm Symmetrical Rail	Qty _____
CLP1	Holddown Assembly for MP008 and MP011	Qty _____
HKB-HK2D-11	Explosion-Proof Housing with MP011 Installed	Qty _____

**DIMENSIONS**

Inches [mm]

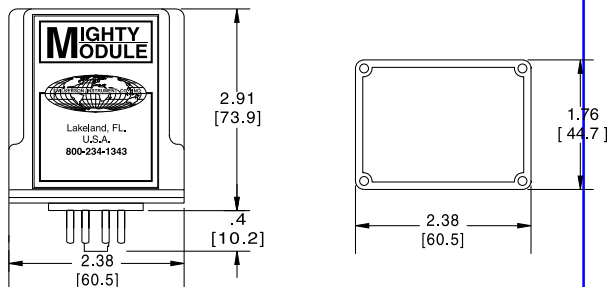

**CONNECTIONS**

PIN 1	Power AC L1 or DC +
PIN 2	No Connection
PIN 3	Power AC L2 or DC -
PIN 4	Input +
PIN 5	Input -
PIN 6	Relay Set 1 NO
PIN 7	Relay Set 1 C
PIN 8	Relay Set 1 NC
PIN 9	Relay Set 2 NO
PIN 10	Relay Set 2 C
PIN 11	Relay Set 2 NC