



FEATURES

- Provides a DPDT Relay Contact Closure at a Preset DC Current Input
- Standard Fail-Safe Operation
- Red and Green LED Alarm Status Indicators
- Adjustable Deadband
- 24 VDC Power Supply for Two-Wire Transmitters
- 4/20 mA Input Range
- 10 + 5 Year Warranty

DESCRIPTION

The MM1005 monitors a DC current input and trips a dpdt, 5 A relay when the input exceeds the desired level. Normal operation has the relay energized for the non-alarm condition and it de-energizes for an alarm condition. This provides a fail-safe alarm condition for loss of power to the module. The alarm has a set of red/green LEDs to indicate alarm status.

The module contains a 24 VDC transmitter power supply specifically designed for use with two-wire and other 24 VDC powered transmitters.

The deadband adjustment allows a deadband of 0.5% to 100% of span to be set into the module. The deadband is symmetrical about the setpoint.

All Wilkerson products are designed with RFI filters and lightning protection to reduce susceptibility to electrical noise and damage by lightning.

TYPICAL APPLICATIONS

HI/LO pressure alarm, level/position control, temperature alarm, etc.

SPECIFICATIONS

INPUT RANGE

4/20 mA

INPUT IMPEDANCE

61.9 ohms

TRANSMITTER POWER SUPPLY

24 VDC regulated,
30 mA max

SETPOINT

0 to 100% of span

DEADBAND

0.5% to 100% of span

RELAY CONTACTS (dpdt)

Resistive Load
5 A max, 150 W max,
220 VAC max, 30 VDC max

Inductive Load

(Power Factor ≥ 0.4)
2.5 max, 75 W max,
220 VAC max, 30 VDC max

TRANSISTOR OUTPUT (Option V)

Relay driver
(12 V coil, ≥ 220 ohms)
or open-collector outputs sink
100 mA, 30 V supply max

RESPONSE TIME

20 ms typical

ACCURACY

$\pm 0.1\%$ of span or 10 μV
whichever is greater

COMMON MODE REJECTION

120 dB, DC to 60 Hz

OPERATING TEMPERATURE

14°F to 140°F/-10°C to 60°C

TEMPERATURE STABILITY

$\pm(0.02\%$ of span + 30 $\mu\text{V})/^\circ\text{C}$
max

POWER

115 VAC $\pm 10\%$, 50 or 60 Hz
(2.5 W max)

230 VAC $\pm 10\%$, 50 or 60 Hz
(2.5 W max)

ORDERING INFORMATION

POWER

- 115 VAC, 50/60 Hz Power
- 230 VAC, 50/60 Hz Power

ALARMS

Alarm Selection - Output

- Relay
- Transistor, O.C.

Alarm Type

- High Low

Alarm Logic

- Normal - Energize On Alarm
- Reverse - De-energize On Alarm

Enter Setpoint Input Level

Setpoint 1

OPTIONS

- Conformal Coating

TAGS

Specify Tag Numbers

Tag number is typed on product label at no charge.

Enter Tag Number(s)

ACCESSORIES

MM1005

DR1	DIN-Rail, 35 mm Symmetrical, 39 inches (1 meter)	Qty _____
MP011	Plastic Socket, 11-Pin, for Flat Surface or PVC Track	Qty _____
TRK48	PVC Snap-Track, 4 ft, for MP008, MP011, & DMP8500	Qty _____
DMP011	DIN-Rail Mounting Socket, 11-Pin, 35 mm Symmetrical Rail	Qty _____
CLP1	Holddown Assembly for MP008 and MP011	Qty _____
HKB-HK2D-11	Explosion-Proof Housing with MP011 Installed	Qty _____

DIMENSIONS

Inches [mm]

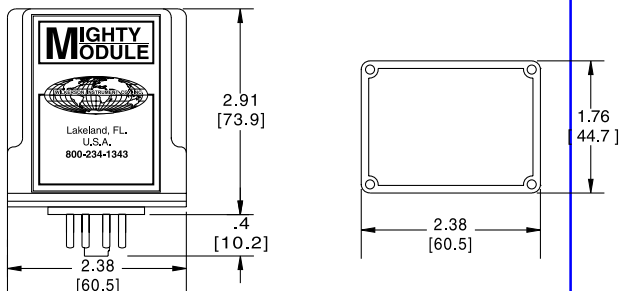

CONNECTIONS

PIN 1	Power AC L1
PIN 2	24 VDC +
PIN 3	Power AC L2
PIN 4	Input +
PIN 5	Input - & 24 VDC -
PIN 6	Relay Set 1 NO
PIN 7	Relay Set 1 C
PIN 8	Relay Set 1 NC
PIN 9	Relay Set 2 NO
PIN 10	Relay Set 2 C
PIN 11	Relay Set 2 NC