



MM4010

DC INPUT NON-ISOLATED TRANSMITTER

FEATURES

- Provides DC Output Proportional to DC Input
- NOT Isolated (for Isolated I/O use MM4380A, MM4300 or MM4300A)
- 50 mV or 1 mA Minimum Input Span
- Unlimited* Choice of Input / Output Ranges
- Choice of Power Options
- 10 + 5 Year Warranty

DESCRIPTION

The MM4010 provides a DC Output voltage proportional to a DC input signal. It is useful in converting a voltage to a current, a current to a voltage, or for scaling signal levels from one amplitude to another.

All Wilkerson products are designed with RFI filters and lightning protection to reduce susceptibility to electrical noise and damage by lightning.

TYPICAL APPLICATIONS

Voltage/current scaling or level conversion, buffering, noise reduction.

SPECIFICATIONS

INPUT RANGE

Voltage

select any range between ± 10 V max**

Current

select any range between ± 5 A max (min span 1 mA)

Current

select any range from 0 to 50 mA max, >24 V compliance (1200 ohms max at 20 mA)

POWER

115 VAC $\pm 10\%$, 50/60 Hz (2.5 W max)

230 VAC $\pm 10\%$, 50/60 Hz (2.5 W max)

(DC Power Option)

24 VDC (limits 21-32 VDC) (2.5 W max)

Isolation, DC power supply to input common: 10 megohms.

* Within specified range limits.

** For input values greater than ± 10 V use MM4380A wide-ranging isolated transmitter.

INPUT IMPEDANCE

Voltage

200 kilohms

Current

Current Input	Input Shunt Value
1 mA	100 Ohm
10 mA	10 Ohm
20 mA	5 Ohm
4/20 mA	61.9 Ohm
100 mA	1 Ohm
1 A	0.1 Ohm
5 A	0.01 Ohm

ISOLATION

Breakdown, Power / Circuitry >1500 VAC rms

RESPONSE TIME (Range Dependent)

≤ 100 ms

WR ≤ 200 ms

ACCURACY

$\pm 0.1\%$ of span

LINEARITY

$\pm 0.01\%$ of span

COMMON MODE REJECTION

120 dB, DC to 60 Hz

OPERATING TEMPERATURE

14°F to 140°F / -10°C to 60°C

TEMPERATURE STABILITY

$\pm (0.02\% \text{ of span} + 30 \mu\text{V}) / ^\circ\text{C max}$

OUTPUT RANGE

Voltage

select any range from 10 V to +15 V, 10 mA max load (min span 0.2 V)

ORDERING INFORMATION

POWER

- 115 VAC, 50/60 Hz Power
- 230 VAC, 50/60 Hz Power
- 12 VDC, Power, Transformer Isolated
- 24 VDC, Power, Transformer Isolated

INPUT

Select Units

- VDC mADC

Enter Input

Zero Scale

Full Scale

OUTPUT

Select Units

- VDC mADC

Enter Output

Zero Scale

Full Scale

OPTIONS

- Conformal Coating

TAGS

Specify Tag Numbers

Tag number is typed on product label at no charge.

Enter Tag Number(s)

ACCESSORIES

MM4010

DR1	DIN-Rail, 35 mm Symmetrical, 39 inches (1 meter)	Qty _____
MP008	Plastic Socket, 8-Pin, for Flat Surface or PVC Track	Qty _____
TRK48	PVC Snap-Track, 4 ft, for MP008, MP011, & DMP8500	Qty _____
DMP008	DIN-Rail Mounting Socket, 8-Pin, 35 mm Symmetrical Rail	Qty _____
CLP1	Holddown Assembly for MP008 and MP011	Qty _____
HKB-HK2D-8	Explosion-Proof Housing with MP008 Installed	Qty _____

DIMENSIONS

Inches [mm]

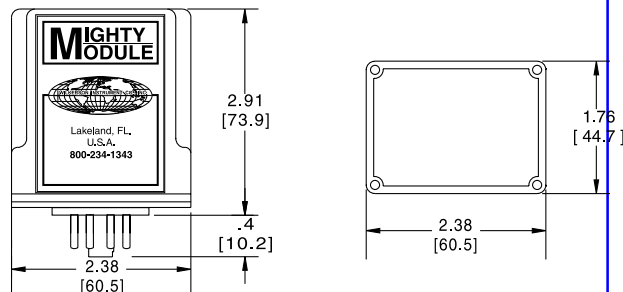

CONNECTIONS

PIN 1	Power AC L1 or DC +
PIN 2	No Connection
PIN 3	Power AC L2 or DC -
PIN 4	No Connection
PIN 5	Signal Input +
PIN 6	Signal Input -
PIN 7	Signal Output +
PIN 8	Signal Output -